

QUARTIER 319 MARITIM

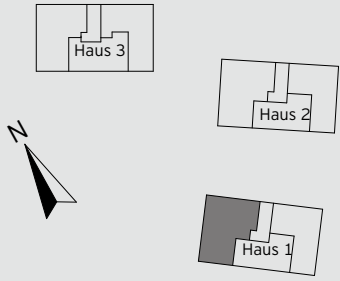

319



WE 05 4 Zimmer

| | |
|----------------|---------------------|
| Wohnen / Küche | 31,2 |
| Flur | 13,3 |
| Schlafen | 13,2 |
| Zimmer 1 | 11,4 |
| Zimmer 2 | 10,0 |
| Bad | 5,1 |
| Duschbad | 4,0 |
| Abst. | 1,9 |
| Loggia | zu 1/2: 3,0 |
| <hr/> | |
| | 93,1 m ² |

 **BEHRENDT**

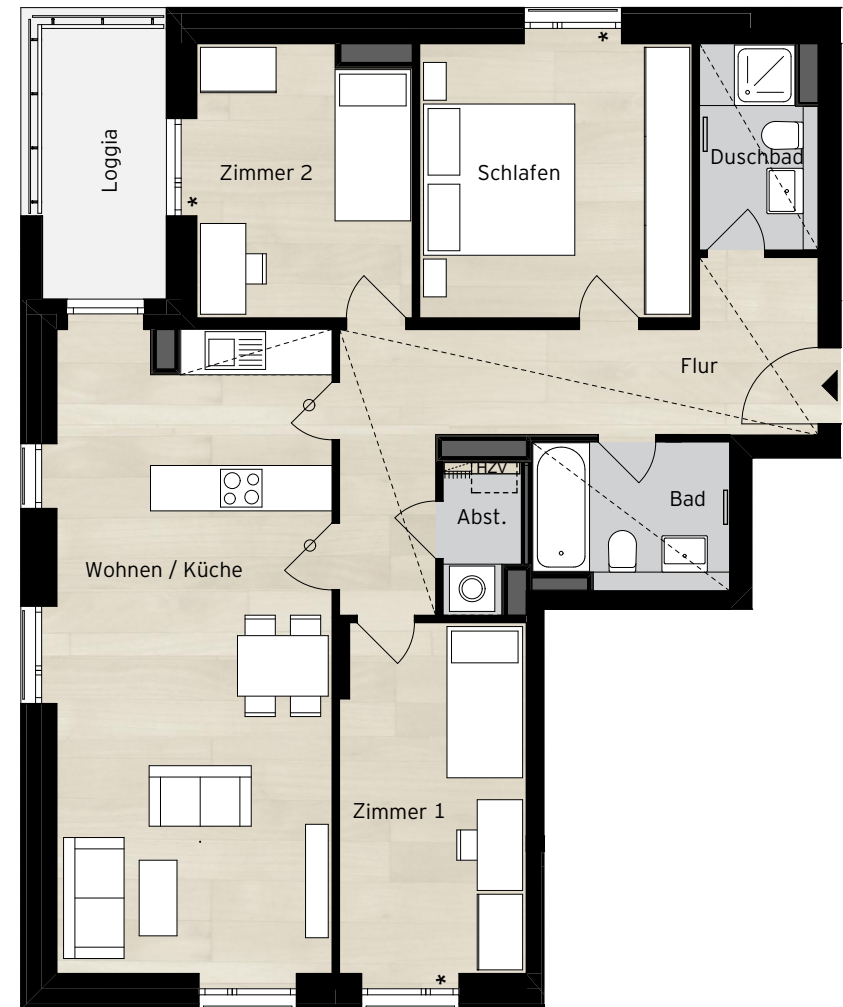

0 m 1 m 2 m 3 m 4 m 5 m

319

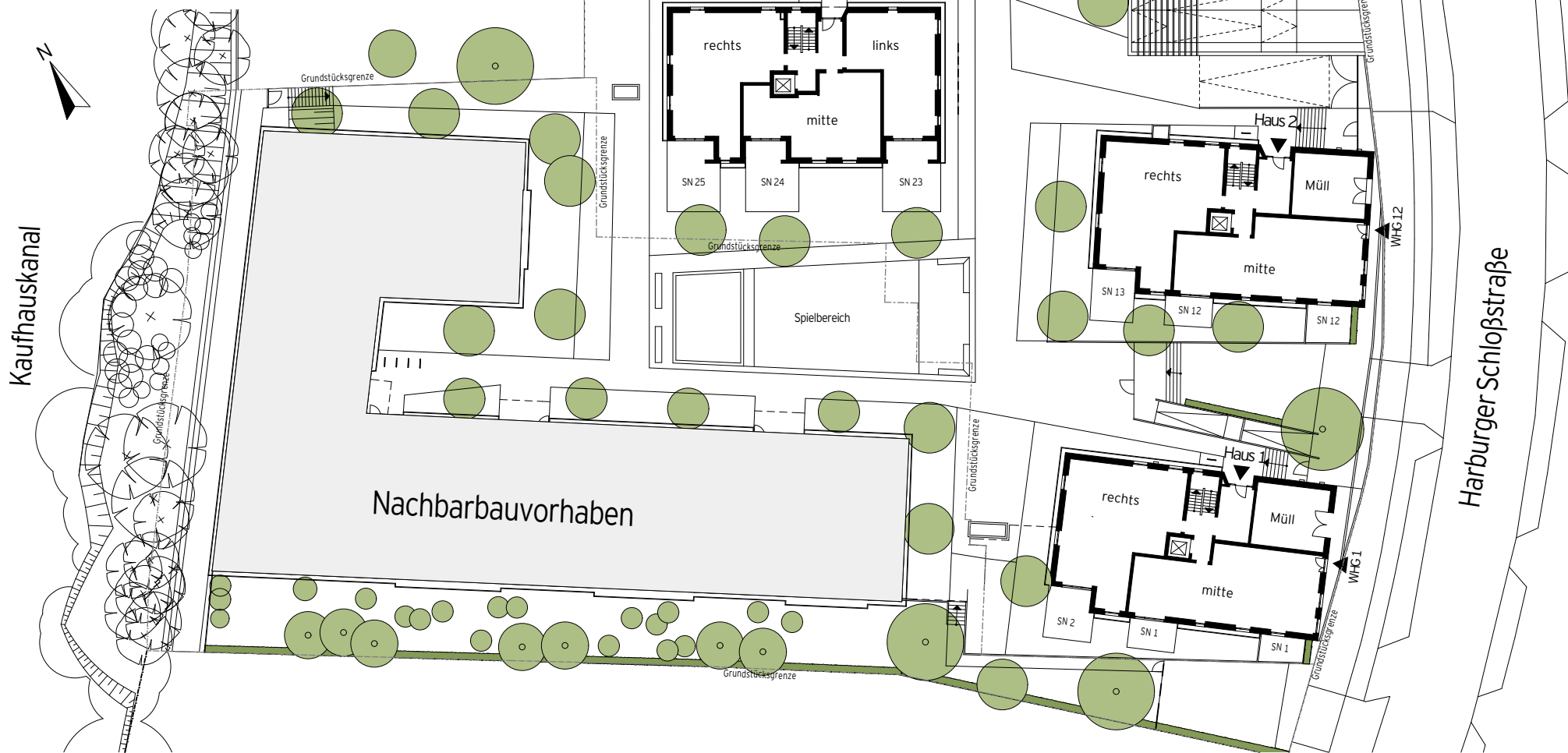

Lageplan

| HAUS 3 | rechts | mitte | links |
|--------|--------|-------|-------|
| 4.OG | 32 | | 31 |
| 3.OG | 32 | 30 | 31 |
| 2.OG | 32 | 30 | 29 |
| 1.OG | 28 | 27 | 26 |
| EG | 25 | 24 | 23 |

| HAUS 2 | rechts | mitte | links |
|--------|--------|-------|-------|
| 4.OG | 22 | | 20 |
| 3.OG | 22 | 21 | 20 |
| 2.OG | 19 | 18 | 17 |
| 1.OG | 16 | 15 | 14 |
| EG | 13 | 12 | |

| HAUS 1 | rechts | mitte | links |
|--------|--------|-------|-------|
| 4.OG | 11 | | 9 |
| 3.OG | 11 | 10 | 9 |
| 2.OG | 8 | 7 | 6 |
| 1.OG | 5 | 4 | 3 |
| EG | 2 | 1 | |



319

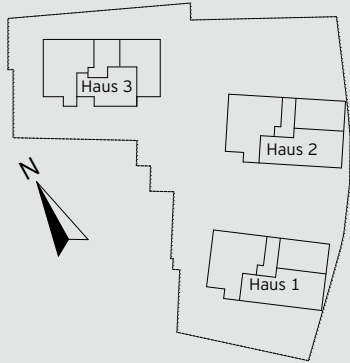

Legende



















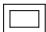

Anlage 1

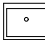
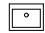
Hinweis:
Alle Maße sind ca.-Angaben und können sich im Zuge der Ausführungsplanung ändern. Abweichungen von 2% der Fläche der jeweiligen Wohnung können sich ergeben.

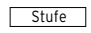
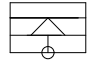
Die Darstellung der Möblierung, die Küchengestaltung und die Ausstattung an technischen Geräten ist beispielhaft und dient lediglich der Anschauung. Den genauen Lieferumfang entnehmen Sie bitte der Baubeschreibung.

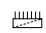
319_1

 **BEHRENDT**

| | | | |
|---|---|---|---|
| ----- | GRENZE SONDERNUTZUNGSRECHT |  | TÜR MIT GLASAUSCHNITT |
| - · - · - | GRUNDSTÜCKSGRENZE |  | TÜR OHNE GLASAUSCHNITT |
| ----- | DECKE ABGEHÄNGT ODER ÜBER DEM BETRACHTER BEFINDLICHE BAUTEILE | — | BADHEIZKÖRPER |
|  | BESTANDSBAUM |  | HEIZKÖRPER |
|  | BAUMPFLANZUNG |  | WASCHMASCHINE |
|  | SOLITÄRSTRÄUCHER |  | DUSCHE |
|  | BÖSCHUNG |  | BADEWANNE |
|  | TG-LÜFTUNG |  | WC-BECKEN |
| SN | SONDERNUTZUNGSRECHT |  | WASCHBECKEN |
| HS | HAUS |  | HANDWASCHBECKEN |
| WE | WOHNEINHEIT |  | BEWEGUNGSFLÄCHE Ø 1,20 m Wohnung erfüllt die Anforderungen des § 52 HBauO |
|  | EINGANG |  | MOBILE HOLZSTUFE |
| BR | BRÜSTUNG |  | TREPPE |
| * | FENSTER MIT SCHALLSCHUTZMAßNAHMEN |  | RAMPE |
| HZV | HEIZUNGSVERTEILUNG | | |
|  | ELEKTRO- U. MEDIENUNTERVERTEILUNG | | |
|  | LÜFTUNGSGERÄT | | |
|  | DACHFENSTER | | |
| | | BODENBELÄGE INNERHALB DER WOHNUNG: | |
| | |  | FLIESEN |
| | |  | PARKETT |

319



Keller- und Tiefgaragenplan

